

Ghiera serraggio
GTS25 RH

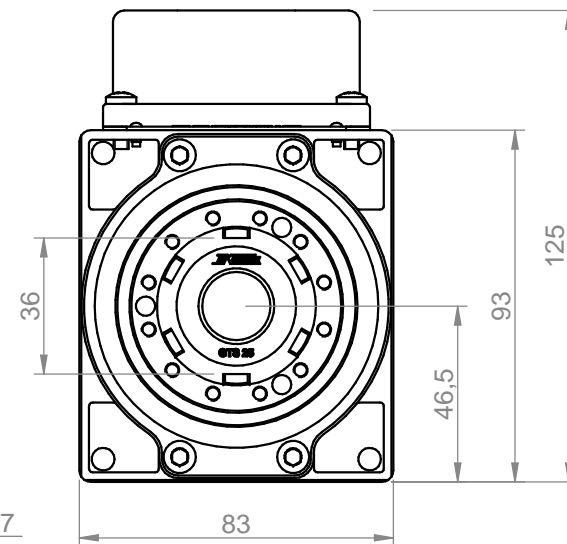
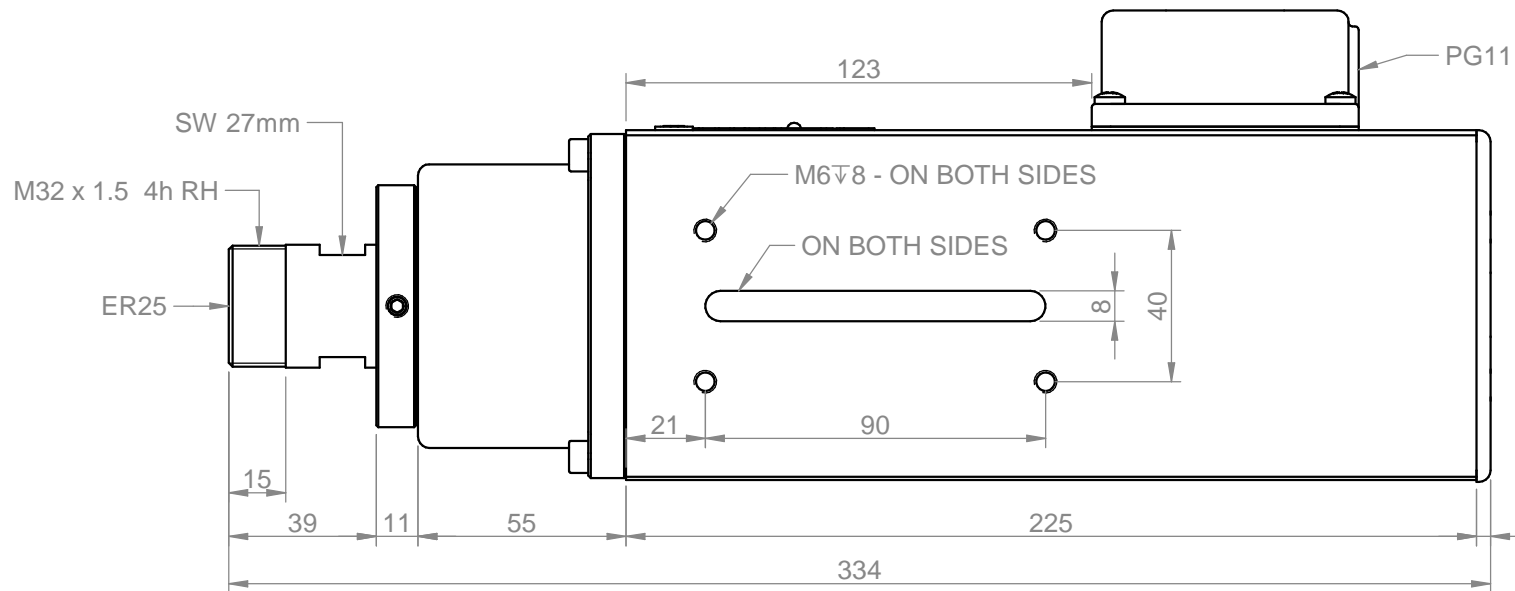
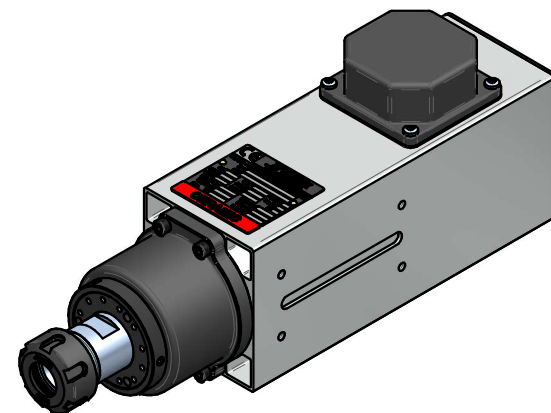
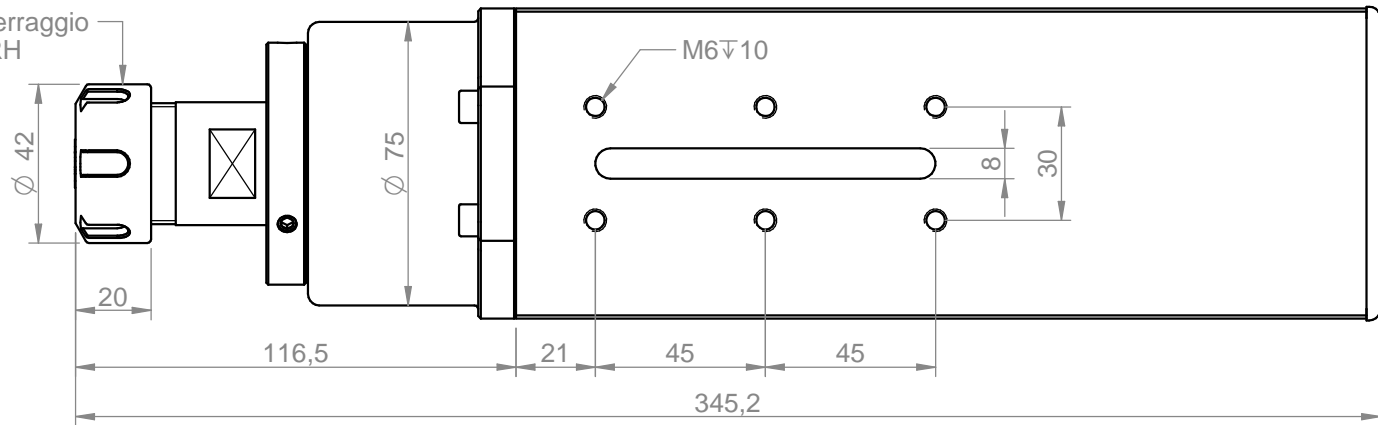

Power [kW]	Duty Cycle	Base speed [rpm]	Base freq. [Hz]	Base voltage Δ [V]	Base voltage Y [V]	Protection	Ins. Cl.
2.2	S1	18000	300	220	380	IP50	F
Min speed [rpm]		Max speed [rpm]	Max freq. [Hz]	Absorb. Δ [A]	Absorb. Y [A]	Part number on nameplate	
6000		24000	400	9.0	5.2	COM41470329	
Balancing: G2.5 - ISO 1940 @ maximum motor speed		Balancing type		tool type full key	tool type half key	Peso / weight	
						8.18 kg	
Tolleranze non quotate / unlisted tollerances: ±0.5mm Smussi non quotati / unlisted chamfers: ±0.5mm				$\nabla = 0.8 \nabla$	$\nabla = 3.2 \nabla$	$\nabla = 12.5 \nabla$	$\sim = \nabla$
rev. n°	description			date	signature		Title
00	Emissione			15/02/2010	D. Bottarel		4147-C-DB-P-ER25-HY-RH
						Customer	
						Catalogo	
						Drawing code	Drawing n°
						COM41470329	4138
drawn - date	approved - date	checked - date	sostituisce il		foglio / sheet	scala	
D. Bottarel - 15/02/2010	S. Perli - 15/02/2010	S. Perli - 15/02/2010	sostituito dal		1 / 1	1:2	

TEKNOMOTOR

Teknomotor S.r.l.
Via Argenege 31, I-32038 Quero Vas (BL)
www.teknomotor.com