

“台”封固

A

B

A

B

C

D

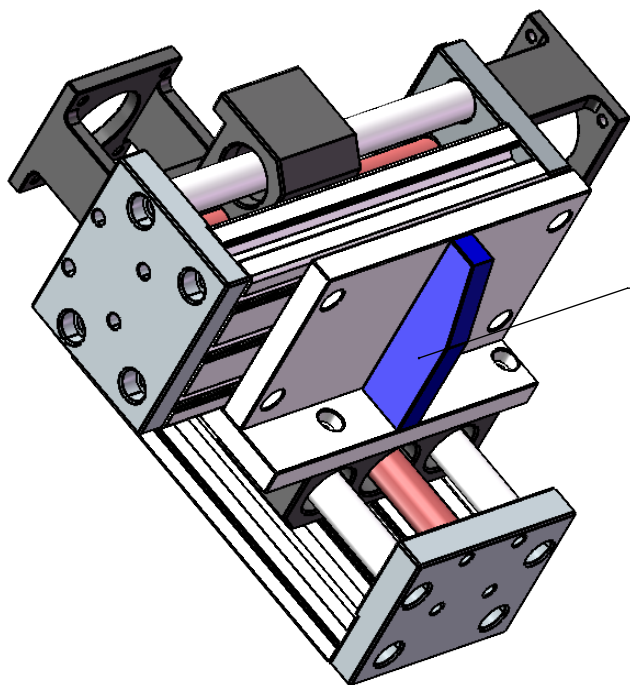

连接板

M5 - 6H ▽ 12
∅ 4.2 ▽ 15

2 x M5 - 6H ▽ 12
∅ 4.2 ▽ 15

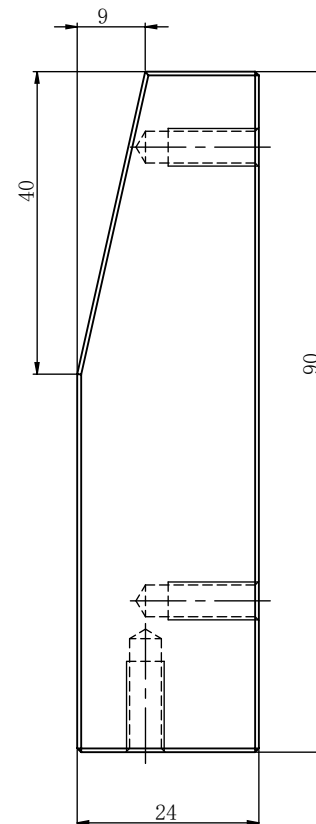
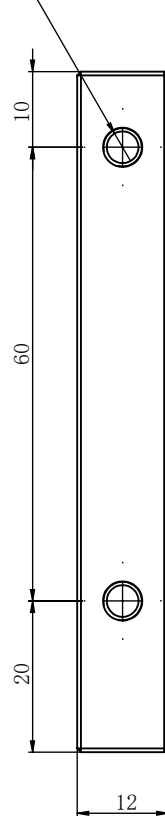
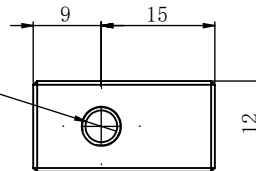

零件代号

借(通)用件登记

旧底图总号

底图总号

签字

日期

简易90悬臂连接板3

时间:2023/7/5

丽水市永润精密机械有限公司