

Rated Voltage (Vac)	<b>200-220</b>
Rated Power (w)	<b>200</b>
Rated Torque (N.m)	<b>0.64</b>
Peak Torque (N.m)	<b>2.23</b>
Rated Speed (rpm)	<b>3000</b>
Peak Speed (rpm)	<b>6500</b>
Rated Current (Amp)	<b>1.9</b>
Peak Current (Amp)	<b>6.6</b>
Torque Const (N.m/Amp)	<b>0.33</b>
Back EMF Const (V/krpm)	<b>21.8</b>
Resistance (Ω)	<b>6.3</b>
Inductance (mH)	<b>12.7</b>
Inertia (kg*m <sup>2</sup> *10 <sup>-4</sup> )	<b>0.29</b>
Poles	<b>10</b>
Encoder type	<b>23bit absolute</b>
Protection level	<b>IP65</b>

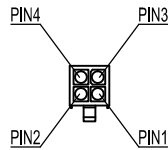
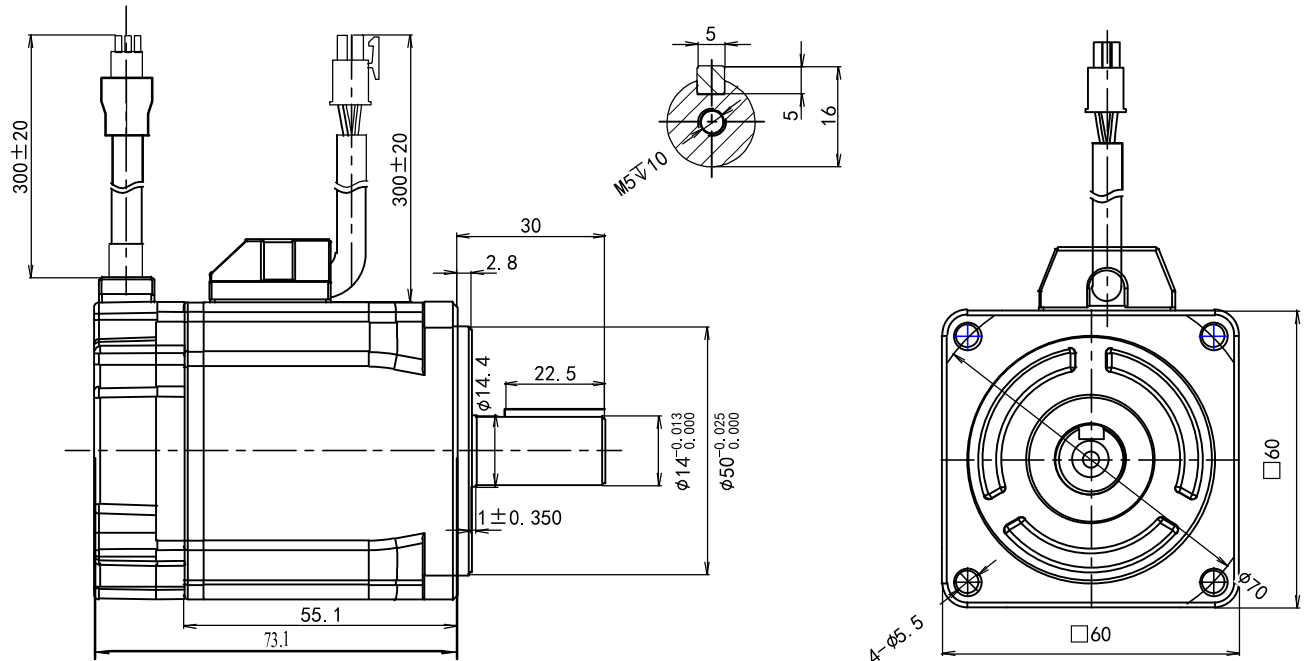

Wiring details of Power cable connector				
Pos	1	2	3	4
Signal	U	W	V	PE
Color	blue	red	black	Yel/Gre

Connector Code Of Extension Cable Side			
Type	Winding Connector	Encoder Connector	Brake Connector
Pin	770904-1	770904-1	--
Plastic shell	AMP172159-1	AMP172161-1	--

Connector Code Of Motor Side			
Type	Winding Connector	Encoder Connector	Brake Connector
Pin	770903-1	770903-1	--
Plastic shell	AMP172167-1	AMP172169-1	--

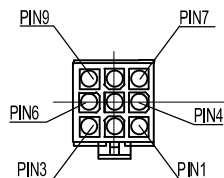

Wiring details of encoder cable connector							
Pos	1	2	3	4	5	6	7
Signal	PE	5V	0V	SD+	SD-	BAT+	BAT-
Color	shield	red	black	blue	yellow	brown	white

Leadshine Technology Co .Ltd

**ELM0200LH60F-SS**

60mm, low inertia, 200w servo motor  
23bit absolute encoder, no brake